

General Notes:

Zoning:	Village centre
Site Area :	0.65HA
Plot ratio:	0.12 max:0.5 - 0.35
Site coverage:	9.2% Max 50%
Residential Density:	15.4 Units/HA Recommended, 15-20 lower in some cases
Open Space:	0.12HA, 18.4% Min 15%
Services:	
Water:	Access to public mains
Foul:	Access to public sewer
Surface Water:	soakaways on site

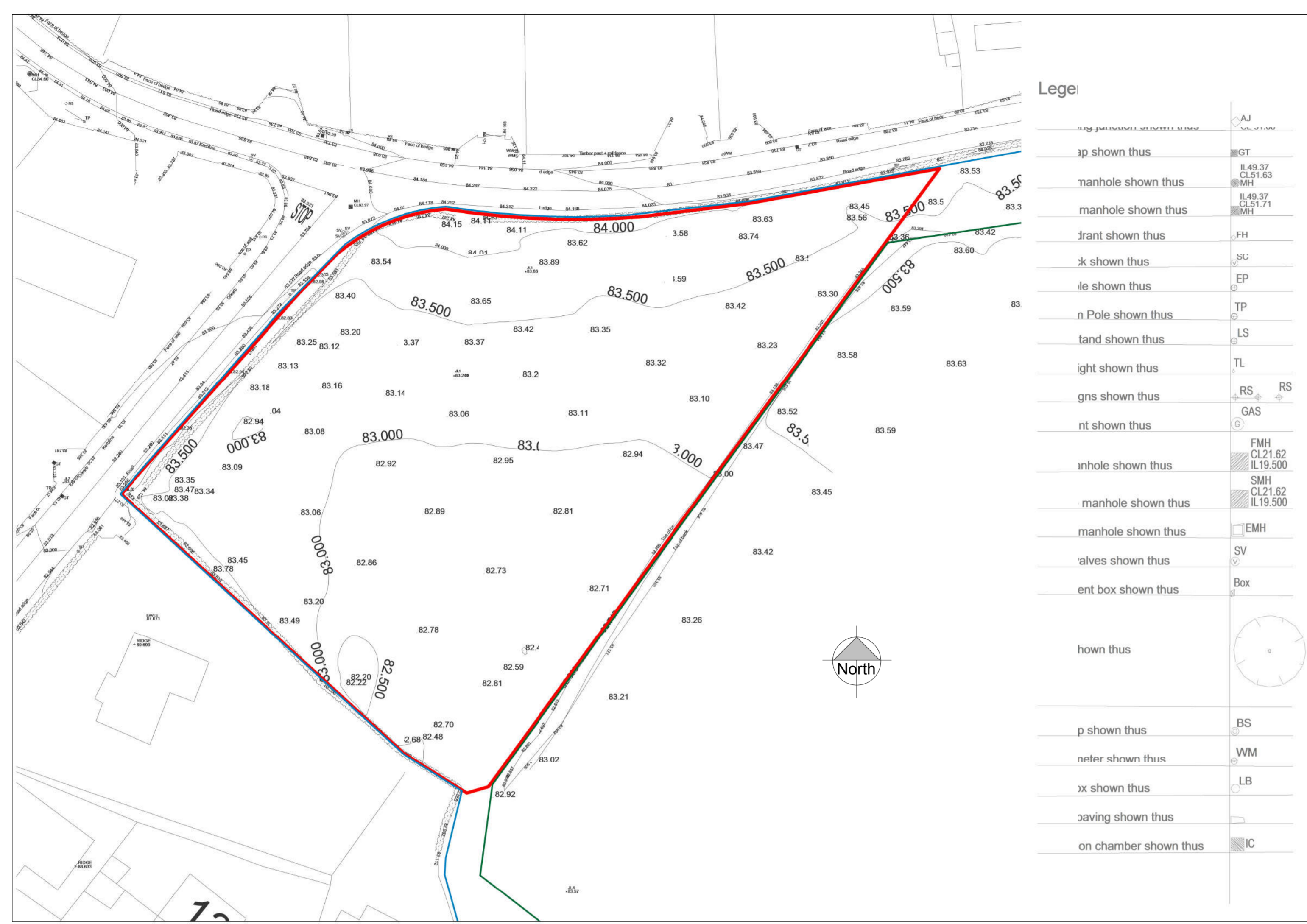

Legend

sp shown thus	AJ
manhole shown thus	GT
manhole shown thus	IL 49.37 CL 51.63 MH
manhole shown thus	IL 49.37 CL 51.71 MH
front shown thus	FH
sk shown thus	SG
le shown thus	EP
n Pole shown thus	TP
land shown thus	LS
ight shown thus	TL
gns shown thus	RS RS
nt shown thus	GAS
inhole shown thus	FMH CL 21.62 IL 19.500
manhole shown thus	SMH CL 21.62 IL 19.500
manhole shown thus	EMH
alves shown thus	SV
ent box shown thus	Box
own thus	
p shown thus	BS
meter shown thus	WM
x shown thus	LB
aving shown thus	
on chamber shown thus	IC



Existing Site Layout Plan - survey
Scale @ A1: 1 : 500



NOTE:
ALL TREES AND SHRUBS TO COMPLY WITH TABLE 17.2 OF THE KILDARE COUNTY DEVELOPMENT PLAN 2017-2023

Extent of site
Lands leased to soccer club
Lands in ownership of KKC

tarmacadam

Cobble lock type a

Cobble lock type b

Lawn-private open space

Lawn-public open space

Tree type 2-Silver Birch- (Betula Pendula) 50mm girth

Tree type 1-Rowan - (Sorbus) 50mm girth

Tree type 1- Ash (Fraxinus) 50mm girth

1. Wall - Entance
2. Wall - Garden Wall
3. post and plank fence
4. Railing -front gardens
5. Wall -railing on wall.
6. Bin screen

Proposed Site Layout-Landscape
Scale @ A1: 1 : 500

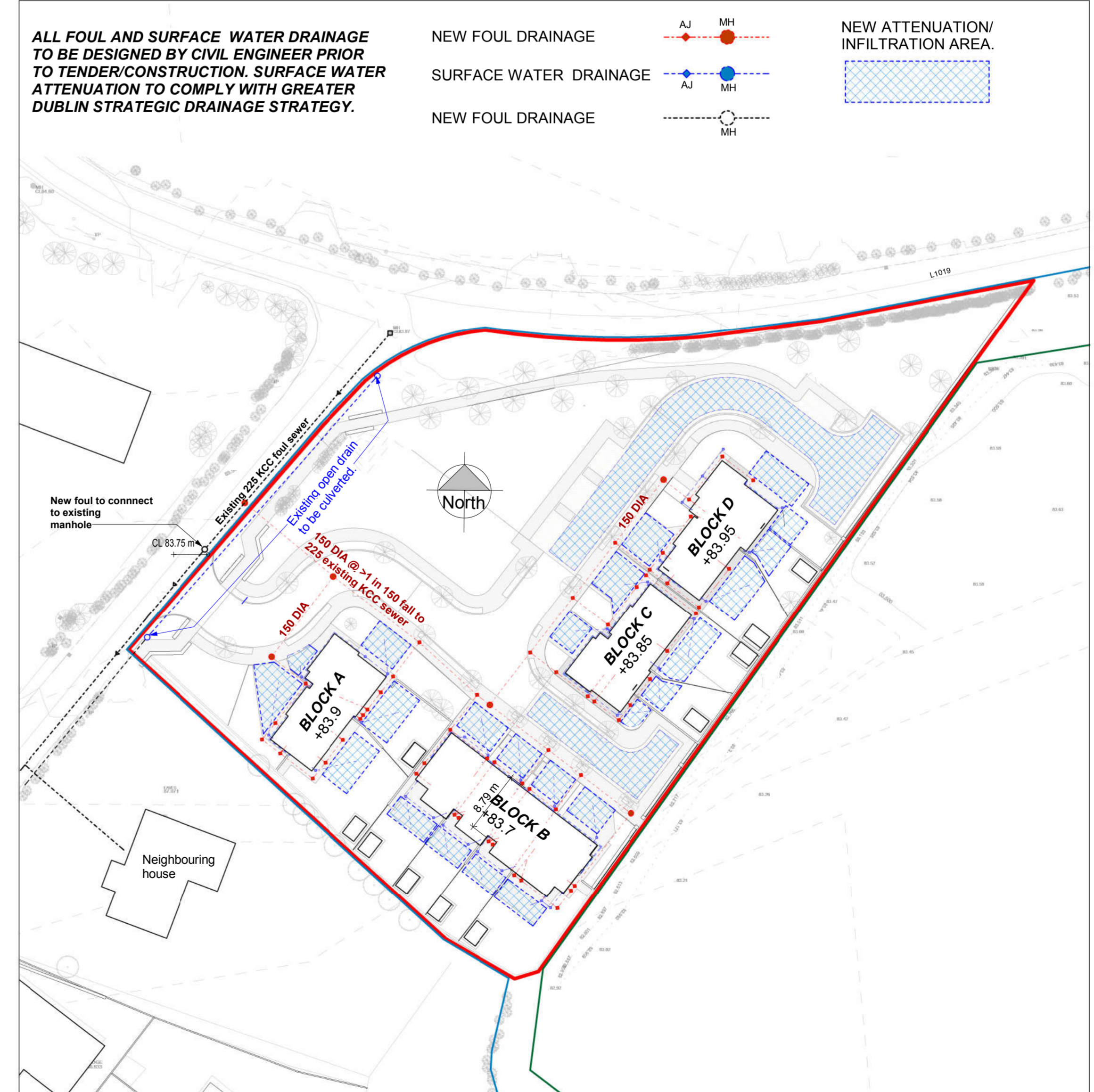

ALL FOUL AND SURFACE WATER DRAINAGE TO BE DESIGNED BY CIVIL ENGINEER PRIOR TO TENDER/CONSTRUCTION. SURFACE WATER ATTENUATION TO COMPLY WITH GREATER DUBLIN STRATEGIC DRAINAGE STRATEGY.

NEW FOUL DRAINAGE	AJ	MH	NEW ATTENUATION/ INFILTRATION AREA.
SURFACE WATER DRAINAGE	AJ	MH	
NEW FOUL DRAINAGE		MH	

Proposed Site Layout- Drainage
Scale @ A1: 1 : 500

PART 8 APPLICATION

- Notes:
- This drawing has been prepared for planning purposes only
 - All drawings to be read in conjunction with all other consultant drawings, Architect to be informed immediately of any discrepancies
 - Figured dimensions only to be taken from this drawing. All dimensions and levels to be checked on site, Architect to be informed immediately of any discrepancies

REVISION

REV	NOTES	DATE

Kildare County Council,
Architectural Services Section,
Devoe Park,
Naas,
Co. Kildare



Project:
Proposed 10 no. Social Houses and associated works at Coill Dubh, Co. Kildare.

Client:
Tadhg McDonnell, Director of Housing

Prepared By: Capital Housing Team,
Architectural Services Section,
Housing Department,
Kildare County Council
Senior Architect: David Creighton, MRAI
Senior Executive Architect: Leitita Hanratty, MRAI
Project Manager: Patrick Henderson, MRAI

Dwg : Survey/landscape/drainage	Project No: 17-027
Scale As indicated@A1	Dwg No: P8-04